

TW(SC/APC) Waterproof Connectors Specifications



Compatiable Mini(SC/APC) Connector



Compatiable Optitap Connector

1.Product description:

TW cable assemblies provide the most cost-effective method of deploying optical fiber in outside plant distribution networks at speeds significantly fast than traditional field installations. The assemblies guarantee an easy, one-step connection system with the combined push-pull insertion and nut-style mechanical latch. TW cable assembly provides quick installation solutions and has good performance on mating with Optitap and Mini(SC/APC) adapter. Cable can be armored or non-armored. TW connector Applications include connection to Remote Radio Units (RRU/RRH), FTTH, FTTH equipment and other outdoor systems. The Unique design of the housing allows it to be provided on a factory terminated and tested cable assembly or retrofitted to existing outdoor cable assemblies.

2.Specification:

Item	Parameter
Insertion loss	≤0.3dB
Return loss	Min. 60 dB
Repeatably	≤0.2dB
Interchangeability	≤0.2dB
Durability	1000 cycles
Operating Temperature	-40 °C ~ +85 °C
Storage Temperature	-40 °C ~ +85 °C
Installation Temperature	-40 °C ~ +85 °C
Waterproofing grade	IP68 (1M,1hour)
Cable diameter range	Ø2.0mm - Ø5.0 mm; 2x3mm Butterfly; 2x5mm Butterfly; 4x7mm flat
Housing material	PC
Boot material	TPV

3.Standards:

Parameter		Specification
Pull	FRP (Pull≥50N)	IEC 61300-2-4
	Steel wire (Pull≥150N)	
	Kevlar (Pull≥80N)	
Vibration		IEC 61300-2-1
Impact		IEC 61300-2-12
Temperature		IEC 61300-2-22
Humidity		IEC 61300-2-22

4. Operation Figure

4.1 Loosen the nut and remove the shell, as shown in the Figure:

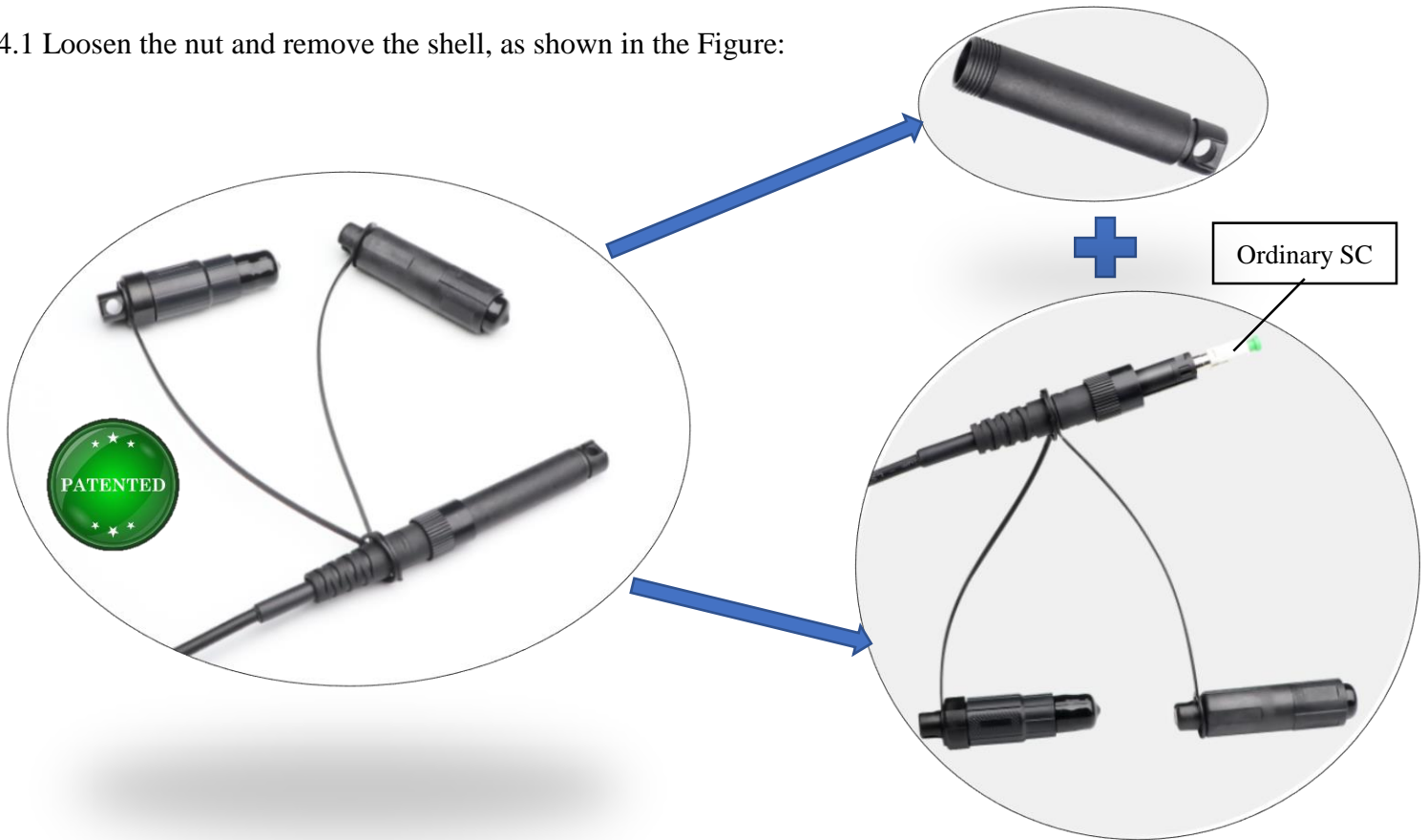

4.2 Cover the Mini(SC/APC) Connector housing and Optitap Connector housing respectively, as shown in the Figure:

